

DS-75i

Folder Inserter

Productive, Versatile and Intuitive



Join us on



NEOPOST

Send.Receive.Connect.

# Productive, Versatile and Intuitive

Combined with our mail management software, the DS-75i is the perfect mail assembly solution.

The DS-75i combines unparalleled ease of use with advanced technology. With its compact footprint, large loading and unloading capabilities, and features such as CIS scanning technology, the DS-75i can process a wide variety of mailpieces for invoicing, monthly statements, direct marketing campaigns and many other applications.

Getting your mail folded and inserted has never been so simple. The intuitive color touch screen of the DS-75i prompts the operator through each step of the process. This scalable system is extraordinarily quiet and designed to fit perfectly into any work environment. With its WiFi and LAN embedded capabilities, it can be connected to your network to enable remote diagnostics and remote assistance to provide help when needed.

## The Complete Document Process

**1** With Neopost's output management software, you can automatically add barcodes, giving more processing flexibility to your documents and guaranteeing your mail integrity.

**2** Select inserts from multiple trays, providing the ability to personalize your mail.

**3** Split your print file based on the number of pages, simplifying mail assembly.



## Environmental Commitment

The DS-75i carries Neopost's Eco-Label which aims to provide a clear and consistent set of environmental performance criteria used in the design phase of our products.



### How We Reduce Our Environmental Footprint:

- Neopost limits the machine weight and the amount of raw materials used for production.
- The volume of our packaging is kept to a minimum and is 100% cardboard and recyclable.
- Packaging for the DS-75i represents less than 20% of the total weight of the packed product.
- The user-friendly sleep mode helps reduce energy consumption.
- We develop our products to ensure a minimum recyclability rate of 75%.

## The DS-75i Offers Flexibility of Configurations



### Increase Productivity

- High-capacity feeder
- MaxiFeeder tray
- High-capacity vertical stacker



### Process Invoices and Statements

- 2 standard feeders
- 1 MaxiFeeder tray
- High-capacity vertical stacker



### Enhance Customer Communications

- 3 standard feeders
- Side exit tray

## 2. Touch Screen Display

The 7" color touch screen enables navigation easily to create a new job or access existing jobs within seconds

## 1. Automated Stacker

The high-capacity vertical stacker holds up to 500 finished envelopes



## 3. CIS Scanner

Internal Contact Image Sensor (CIS) scanner can read OMR, OCR, 1D and 2D codes printed horizontally or vertically on the document

## 4. Document Feeders

Process multiple page sets at high processing speeds using three standard feeders holding up to 975 documents (3 x 325). While in cascade mode, feeder sensors ensure continuous operation

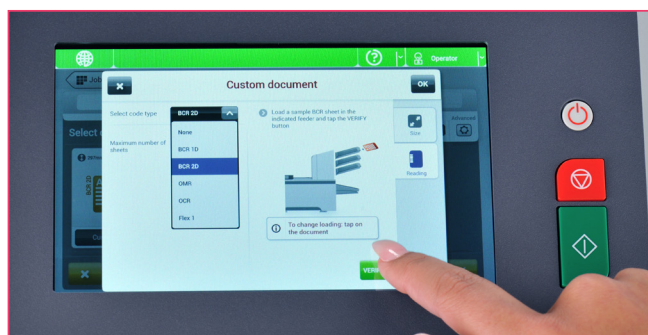

### A State-of-the-Art Graphical User Interface

Designed for all users, the intuitive, full color, high-resolution 7" touch screen provides a wizard-based user-friendly interface, making it easy for anyone to select and run their folding and inserting jobs.

Alternatively, see how easy it is to create a new job. Simply load your documents and envelopes and press the start button. The DS-75i will automatically measure the length of all loaded documents, as well as the envelope, in order to adjust all settings and process the appropriate mail items.



### Smart Solutions to Maximize Flexibility

The exclusive FlexFeed® tray enables you to process many different document sizes. In combination with the unique semi-automatic envelope separation mechanism, this provides full flexibility for feeding a wide variety of document types. You can use practically any size and type of material to address your prospective and current customers efficiently.

### Optimize Productivity with the MaxiFeeder Tray

Choose to load the MaxiFeeder with up to 325 BRE or load up to 1,200 sheets to maximize your productivity.

## Specifications

Processing speed	Up to 3,800/hour
Color touch screen	Standard
Automatic settings	Standard
Job memory	50
Feeders	Up to 3
Hand feeding	Standard
Multi-sheet feeding	Standard
Cascade from feeders	Standard
Document feeder capacity	325 sheets (20 lb.)
High capacity feeder capacity	725 sheets (20 lb.)
Envelope feeder capacity	325
Folding capacity (one set, single fold)	Standard (Up to 10 sheets 20 lb.)
Automatic double detection	Standard
Accumulate before folding	Standard
High capacity vertical stacker	Up to 500 envelopes
Tip-to-tip sealing	Standard
LAN embedded	Standard
WiFi embedded	Standard
Noise level	66 Db
Fold types	Letter, z-fold, single, double, parallel, no fold $\triangle Z \angle \llcorner \_$
Document height	3.5" - 14"
Document width	5.1" - 9.1"
Envelope length	3.5" - 6.35"
Envelope width	6.3" - 9.7"
Maximum insert thickness	1 mm
Maximum set thickness	2.5 mm

## Options

MaxiFeeder capacity	1,200 sheets (20 lb.)/325 BRE
Side exit	Up to 400 envelopes
Mailing system interface	Available
Barcode Reader (BCR) for 1D and 2D barcodes	Available
Optical Mark Recognition (OMR)	Available
Optical Character Recognition (OCR)	Available
Output Management Software (OMS)	Available
Remote Assistance	Available
Remote Diagnostics	Available

## System Dimensions

### Length x Depth x Height

DS-75i (3 feeders with catch tray)	50" x 20" x 29"
Weight	175 lbs.

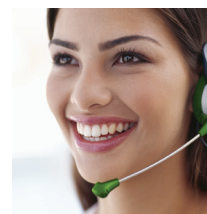

## We've Got You Covered

Neopost maintains a network of offices across the country to provide local customer support and trained technicians who are ready to assist you. You can be confident that when you need knowledgeable support or expert service, the point-of-contact will be a Neopost office in your area consisting of a team of local professionals.

## Why Choose Neopost?

Neopost is a global leader in mailing solutions, shipping services and digital communications. We believe that people are the key to business success. That's why our products and services are tailored to help your organization improve the quality of its interactions and bring people closer together.

In this age of multichannel communications, we guide and empower you to interact in new and innovative ways. We advise you on how to create cost-cutting synergies. We deliver global coverage with a strong local presence, offering you continual support by phone, onsite or online.

Today, Neopost is present in 31 countries and has a network of partners in more than 90 countries. We promote responsible business and sustainable development through our products and outreach programs. Our 6,200 employees worldwide are committed to making your interactions more responsive and more powerful – offering you a competitive edge that will open up a wealth of business opportunities.

Find out more at [neopostusa.com](http://neopostusa.com)